



56 Jackson Drive, Drouin Vic 3818
Owners Corporation PS 641855N
A B N 4 0 6 5 0 5 2 3 9 4 8
countryclub@jvoc.net.au

Alcohol Policy

Version	1.1
Create Date	12 th August 2016
Last Updated	12 th July 2023

Purpose

The purpose of this policy is to ensure that all users of the Jackson's View Country Club are able to engage in moderate alcoholic beverage consumption and to protect the well-being of all lot owners, JVCC property, its assets and the community from harm caused as a result of inappropriate or excessive alcoholic beverage consumption.

Definition

For the purpose of this policy the following definitions apply:-

- "JVCC" is defined as the Jackson's View Country Club, 56 Jackson's Drive Drouin
- "JVOCC" is defined as the Jackson's View Owners Corporation Committee.
- "Lot Owner" is defined as a financial member of the Jackson's View Owners Corporation whose fees are up to date
- "Tenant" is defined as a resident of a property owned by a lot owner that has a valid lease agreement with the lot owner and has exclusive occupation of the leased property.
- "Club Administrator" is defined as Jackson's View Country Club Administrator.

Policy

The Jackson's View Country Club recognises and emphasises that it is against the Liquor Control Reform Act 1998 to;

- Provide alcohol to an intoxicated person
- Provide alcohol to any person under the age of 18
- Allow intoxicated, disruptive or violent behaviour to occur on the premises
- Drive with an illegal blood alcohol concentration

Alcoholic beverages and their consumption are only permitted in designated areas. Refer to the Section "Map defining areas where alcohol can be consumed".

Alcohol should only be consumed under strict conditions, to ensure the safety and well-being of all users of this facility, including the integrity of the facility itself and the equipment herein.

Anyone found to be intoxicated at the premises will be asked to leave immediately and must abide by that request. Anti-social behaviour will not be tolerated under any circumstances. If there is a need for security to attend to the removal of a person/s, then this cost will be borne by the Lot Owner. Failure to comply will attract serious breach

penalties for both the Lot Owner, the Tenant and, if applicable, their Guest(s).

Neither the JVOCC nor its staff & management will be held responsible, nor liable, for any injury caused to persons, or any damage to the Jackson's View Country Club premises (inside and outside), caused by persons who are under the influence of alcohol or any other substance. Inappropriate behaviour may result in Police being notified.

The implementation of this policy by the JVOCC on behalf of the JVOCC assumes that anyone partaking in alcoholic beverage consumption does so on the basis that any damage or injury caused as a result of their consumption of alcoholic beverages will be the responsibility both severally and jointly of the Lot Owner and/or Tenant and/or, if applicable, their Guest/s.

It is a further condition of the permission of alcohol consumption that anyone consuming alcohol indemnifies the Jackson's View Country Club, its staff and management from any litigation as a result of damage or injury resulting from behaviour due to their or their Guest/s intoxication.

Specifically;

- Persons utilising the facilities at the Jackson's View Country Club may ONLY bring alcohol for their OWN and their Guest's consumption.
- The selling of alcohol is strictly NOT permitted.
- Intoxicated and/or anti-social behaviour is strictly prohibited.
- Alcohol is only permitted in the areas blocked in green on the diagram in the section of this policy labelled "Map defining areas where alcohol can be consumed"; being the servery, function room, dining/meeting room, and the external under cover dining areas.
- Any person participating in the consumption of alcohol indemnifies the Jackson's View Country Club Owners Corporation, its staff and Owners Corporation management from any litigious actions brought about as a result of their intoxicated behaviour, and further accepts reparation/replacement responsibility for any damages to property or equipment as a result of same.
- STRICTLY NO alcohol is allowed in the following areas; outside of the premises, entry, foyer, kitchen, toilets, gymnasium, pool, spa and grass areas.
- Alcohol may NOT be consumed by, provided to, or brought into the Jackson's View Country Club by anyone under the age of 18 years.
- Any unconsumed alcohol MUST be removed from the premises on leaving the building.
- All bottles cans or otherwise MUST be disposed of and either taken home for disposal OR placed into the appropriate recycle bin BUT at no time should these items be left lying around the facility.
- Failure to comply with all club rules and regulations may result in the Lot Owner or Tenant losing access to the club and its facilities for a prescribed period of time.

Map defining areas where alcohol can be consumed

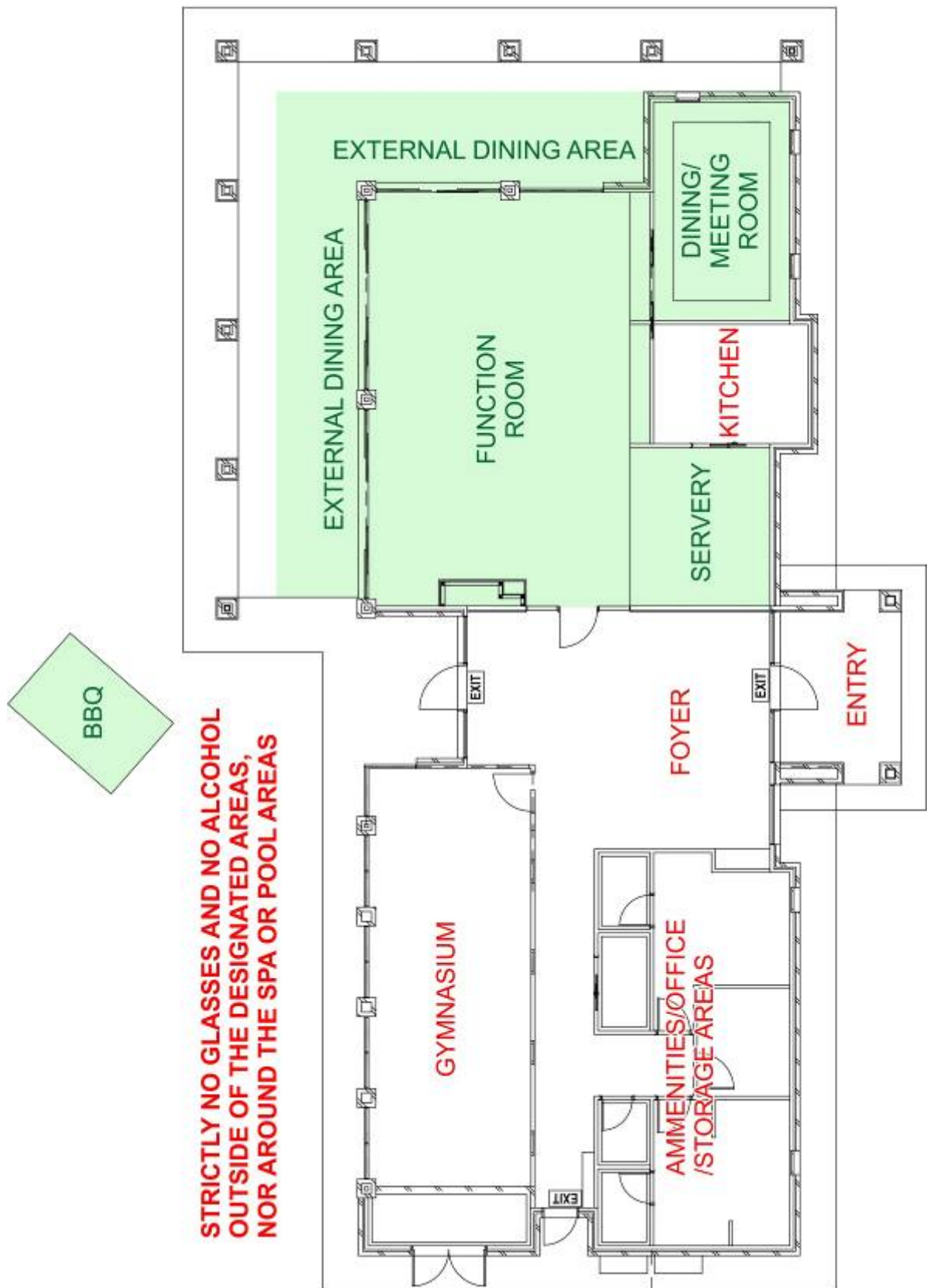

Document Control

Version	Comments	Date
0.1	Updated using new template	12/08/2016
0.2	Reviewed and endorsed by the Policy & Procedure Committee	23/08/2016
0.3	Updated Map	25/09/2016
1.0	Final Version approved by Owners Corporation Committee	03/10/2016
1.1	Minor literals edits	12/07/2023

Document Approval

Date	Approved by
3 rd October 2016	Meeting of the Owners Corporation Committee Meeting.
12 th July 2023	Email approval from JVOCC